



BEENLEIGH FESTIVAL OF ONE-ACT PLAYS

ENTRY FORM 2017

AUGUST 4,5,6

Please return this form, completed, to Beenleigh Theatre
Group Inc.

P.O. Box 201, Beenleigh Qld. Marked 'FESTIVAL ENTRY'

CHECK LIST

SCRIPTS x 3

COMPLETED ENTRY FORM WITH **SIGNED CONDITIONS OF ENTRY**

STAGE PLAN SHEETS

1 x Stage Setting

1 x Lighting

PERFORMING RIGHTS CONSENT

A SHORT SYNOPSIS OF PLAY (WITH PHOTO)

If possible

PAYMENT AND PAYMENT SLIP (if paying by cheque, money order or credit card)

OR

COPY OF RECEIPT (if paying online)

Thank You,

Roslyn Johnson
Festival Coordinator

NB: Entries cannot be processed when information is not to hand, no processing will be done until ALL components are received. PLEASE check you have included ALL these components as part of your entry.

ENTRY FORM

PLEASE SUBMIT A SEPARATE FORM FOR EACH ENTRY

(Additional forms can be found on website. Photocopies will be accepted)

GROUP: _____

ADDRESS _____ **POST CODE** _____

EMAIL ADDRESS: _____

Please print clearly

CONTACT PERSON: _____ **PH:** _____

NAME OF PLAY: _____

PLAYWRIGHT: _____

SECTION ENTERED: *Open* *Youth* **PLAYING TIME** _____

GENRE: *Comedy* *Drama* *Other*

RECOMMENED RATING: *G* *PG* *M* *MA* *R*

REASON FOR RATING (for program inclusion) eg Adult concepts, Occasional Coarse Language etc. _____

IS YOUR PLAY AN 'ORIGINAL' SCRIPT – YES/NO *[see rule 8]

IS YOUR ENTRY AN AUSTRALIAN WORK YES/NO.

NAME OF DIRECTOR: _____

STAGE MANAGER: _____

DESIGNATED CREW MEMBER: _____

LIGHTING DESIGNER _____ **SOUND DESIGNER:** _____

AVAILABILITY TO PERFORM:

Please mark the sessions you are able to attend in order of preference. If there is a session which is impossible for you to attend, please mark with an 'X'.

NB Times may change due to scheduling, but are a good guide as to what sessions will be planned.

Friday		Saturday		Sunday	
Opening Ceremony 7.00pm		Morning session		Morning session	
Evening session		Afternoon session		Afternoon session	
		Evening session		Closing Ceremony Approx. 5pm	

CAST LIST

(If insufficient space, please attach separate sheet)

CHARACTER

ACTOR

Please indicate with * if performer is 18 or under

SYNOPSIS OF PLAY: (Approx. 25 words)

PERFORMANCE RIGHTS: Please read the rules and conditions in Part 1 of the Info-pack and sign below.

We confirm that permission to perform the play has been obtained/attempted to be obtained (attach proof), and agree to abide by the rules and conditions of the Beenleigh Festival of One-Act Plays 2017.

ARTISTIC DIRECTOR/ PRESIDENT of your Group

Name:

Signature:

Date:

SPECIAL CONDITIONS

I have read and agree to abide by the rules and conditions of the Beenleigh Festival of One-Act plays 2017

Special conditions: Our entry **does/does not require special consideration as per rule No. 14. [Please circle]*

DIRECTOR OF PLAY:

Name:

Signature:

Date:

PAYMENT DETAILS:

(Be sure to enclose with your entry form and scripts)

ENTRY FEES: (Please submit a separate entry package for each play)

OPEN SECTION

\$30.00

YOUTH

\$20.00

NAME OF GROUP: _____

PAYMENT:

OPTION 1 Please find enclosed Cheque/Money Order for \$ _____ being entry fees due by June 23, 2017

OPTION 2 Please find attached copy of online transaction for \$ _____ to account name **Beenleigh Theatre Group Inc BSB 034605 account 333890**

**OPTION 3 Please find attached credit card details for payment of \$ _____
being entry fees due by June 23, 2017**

Type of card (please circle) *Visa* *MasterCard*

NAME ON CARD: _____
Please print

Card Number:

--	--	--	--	--	--	--	--	--	--	--	--	--	--	--	--	--	--	--	--

Expiry Date

--	--	--	--

****CCV**

--	--	--

***If you leave this blank please provide a number for us to call when
processing payment _____***

STAGING PLAN

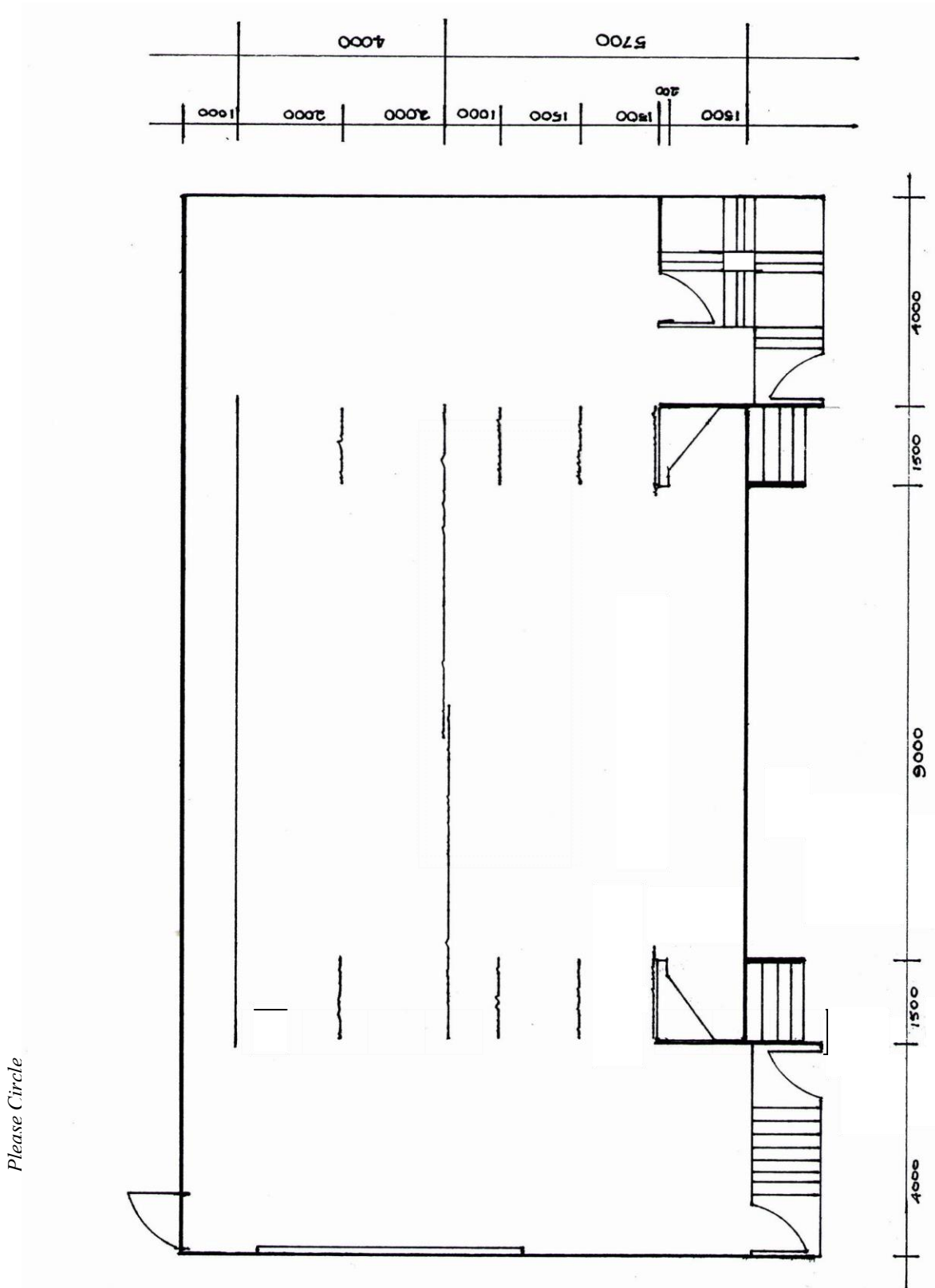

LIGHTING PLAN

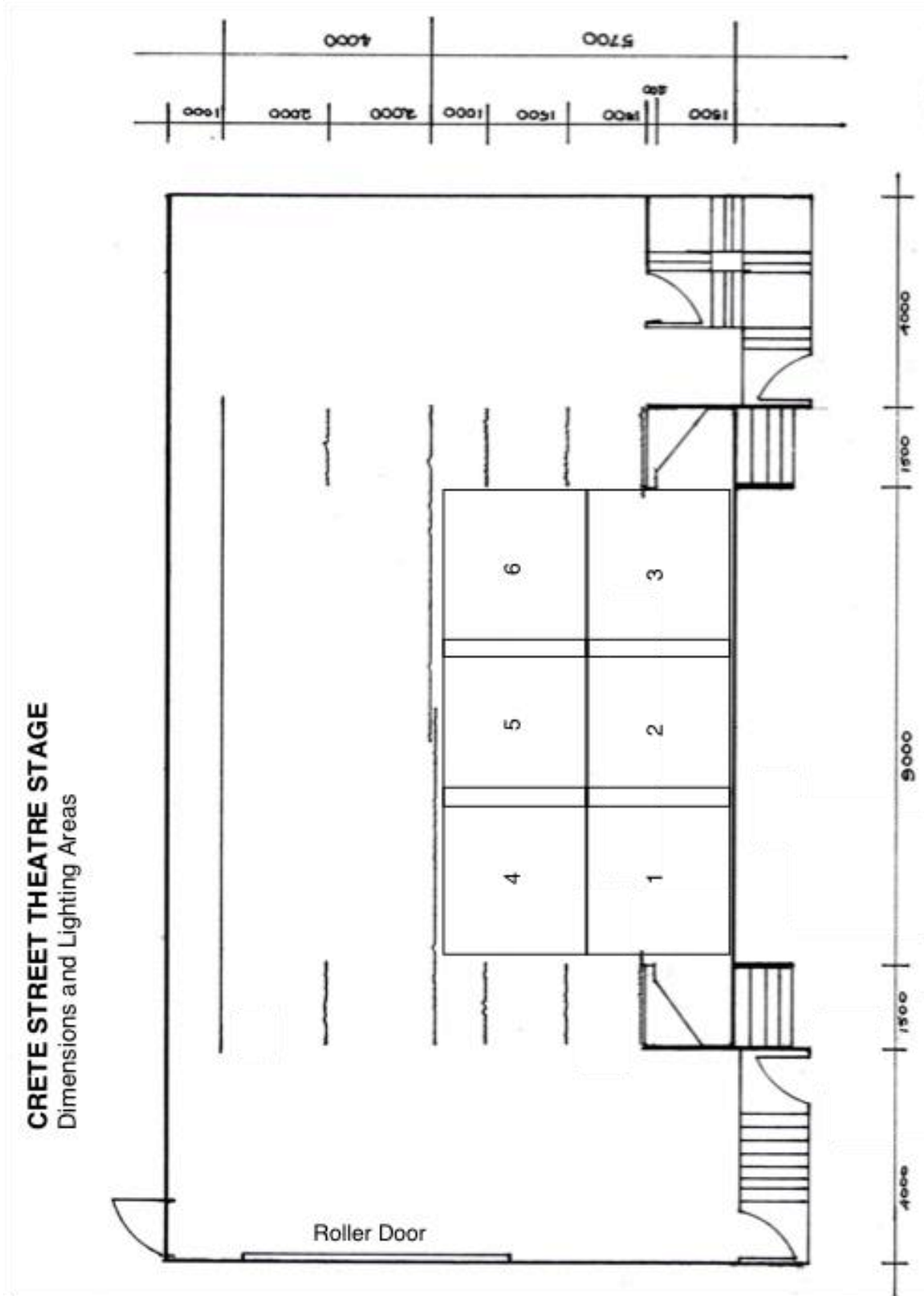

Beenleigh Theatre Group Inc.
PO Box 201, Beenleigh Q 4207

(07) 3807 3922
www.BeenleighTheatreGroup.com